

PASS CONNTACTOR

AEX/CP1

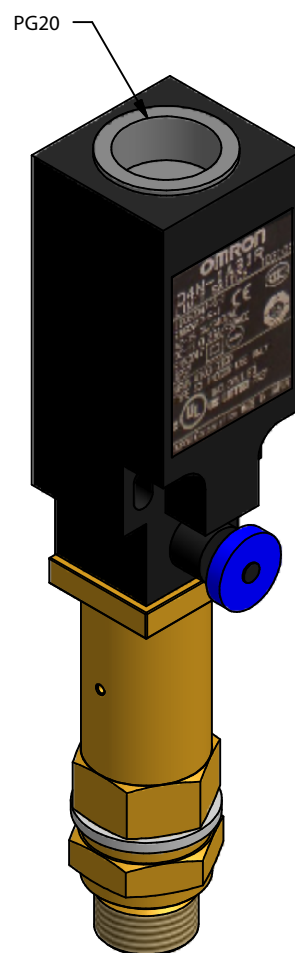
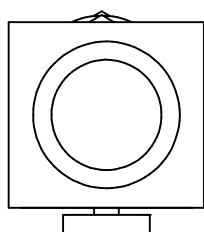
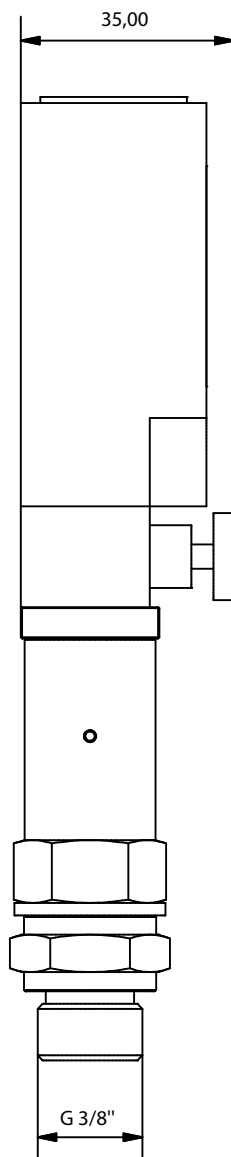
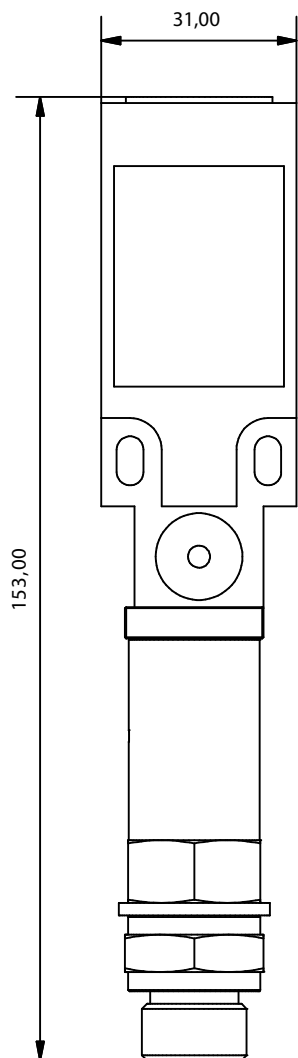

Specifications	
Name	Value
Body material	Brass
Marking	CE
Standard	EN50047
Alternating current	3A/240VAC
Direct current	27A/250VDC
Protection	IP67
Weight	245 g

Description: Element used to provide an electrical signal at the time of discharge. It has one contact normally open and another normally closed.

Code sheet:	Group sheet:	Reference:	Drawn:	Date:	Revised:	Date:	Review:	Format:
AEX-FTC-02-039	CO2	AEX/CP1	DCM	27/08/2015	MRC	27/08/2015	1	A4